

Long Riveter

Manual Long Riveter for deep application of RiveStop devices



It allows sealing from one side



Process safety is increased



Cost savings in process

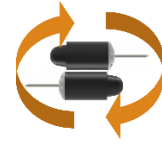

Choose sense of placement

1. TECHNICAL CHARACTERISTICS

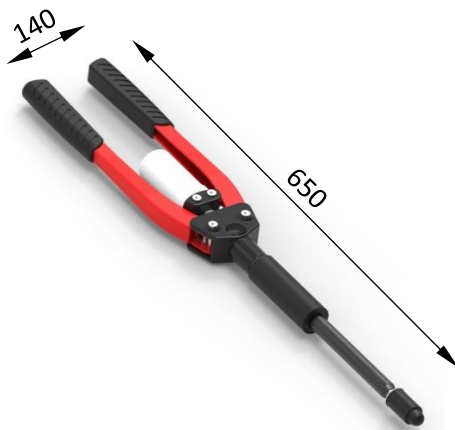

Weight	1,86kg
Application Range	Ø20,5mm – Ø35mm

ADJUSTABLE DEPTH

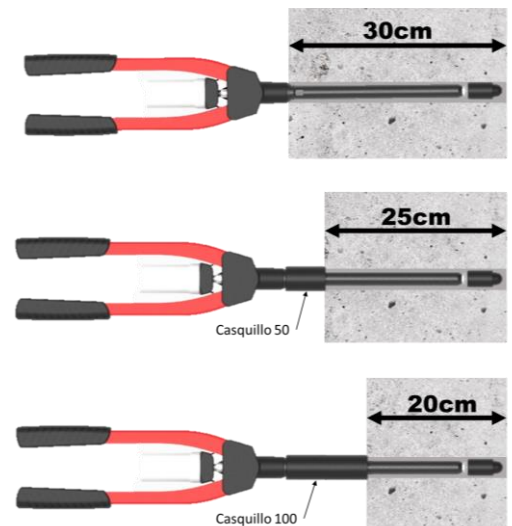

1. INSTALLATION PROCESS

The long riveter is used exactly like a normal riveter, without complications, with an easy and comfortable use that a riveter should have.



1. Insert deep adjustment sleeve.

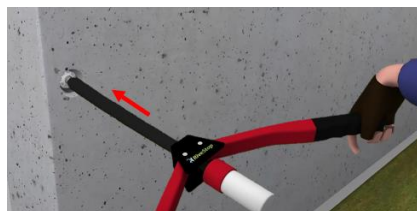

2. Insert into the hole to be sealed.



3. Rivet up until the rivet shank is cut.

1. REMOVAL AND REPLACEMENT OF COMPONENTS

The riveter disassembly process is simple and intuitive. To carry it out, common tools are used, easily acquired and normally present at every workplace.



If you need to remove the other sleeve, use a number 26 spanner.



If you need to remove the inner tie rod, use a number 13 spanner.

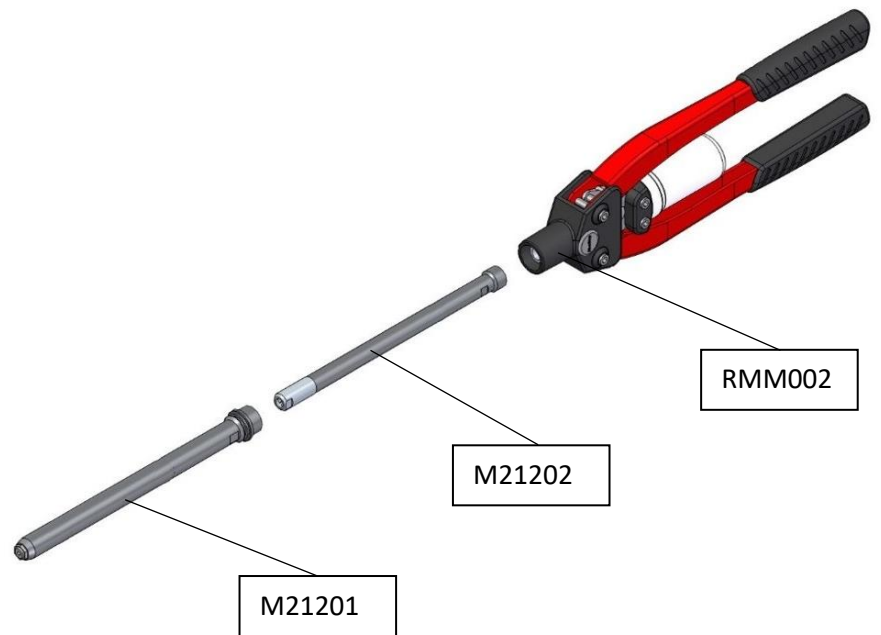

If it's necessary to replace any part of the riveter, it can be ordered separately according to our reference and description.

4. PRECAUTIONS

For a correct durability of the riveter, it's necessary not to incur in an inappropriate use that could cause a premature deterioration and shorten the service life.



Don't force the use of the riveter by subjecting it to bending forces. Avoid handling or leaning with force greater than 50 kg.



Avoid leaving the riveter in harmful environments, such as salty environments or outdoors for long periods of time.



Don't throw or strike the riveter against the ground or against blunt objects.